

475 SANSOME

9,610 RSF

Brand New Spec Suite Available Now

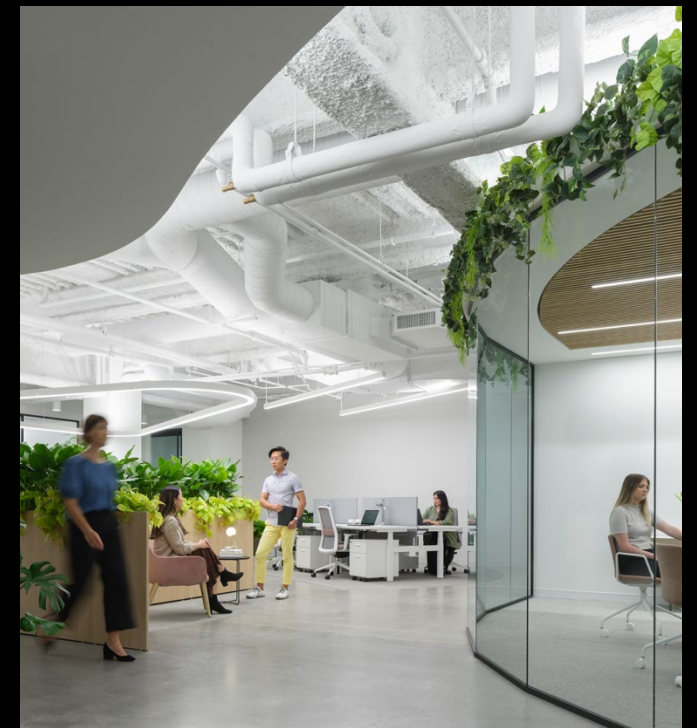
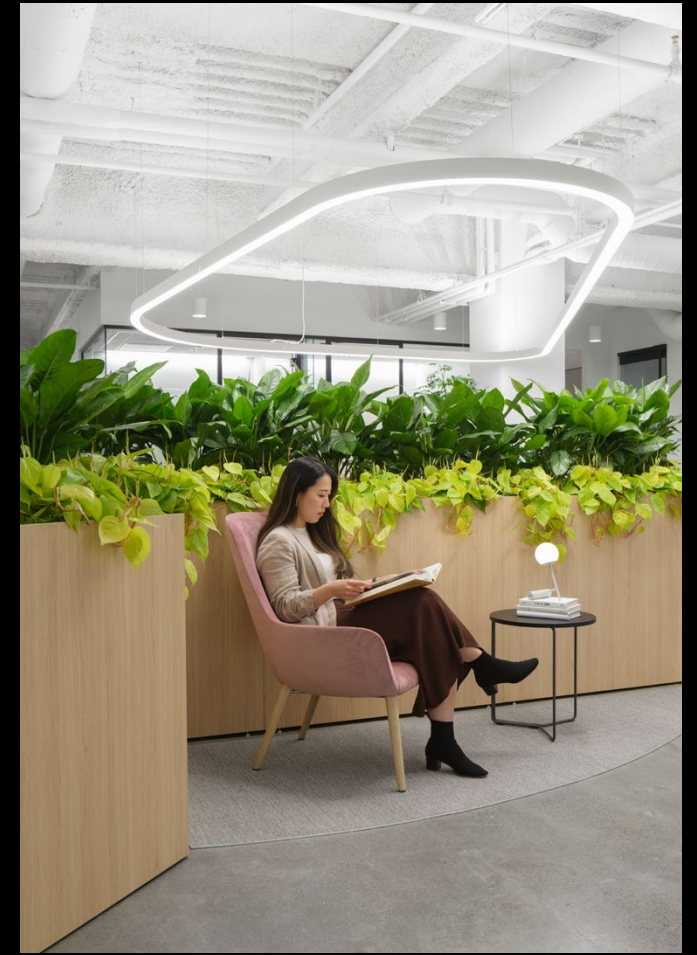

475 SANSOME

Suite 500 - 9,610 RSF

Available Now

Brand New Spec Suite

Fully Furnished

Exposed Ceilings

Partial Polished Concrete

2 Conference Rooms

2 Offices

2 Phone Rooms

Open Area for ±40 Desks

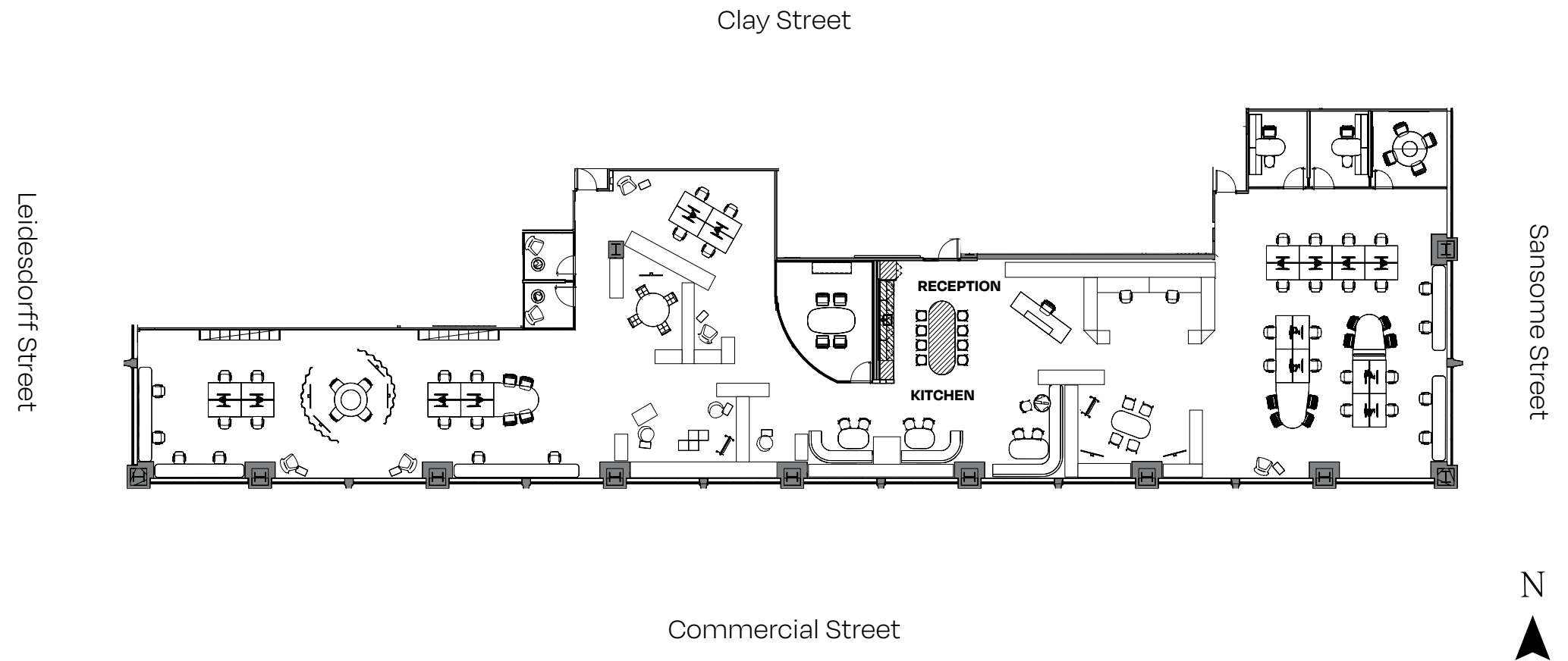
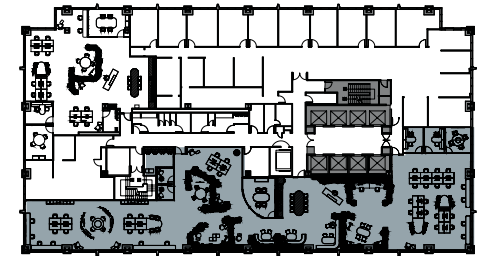

Contact Our Leasing Team

Trent Holsman

510 604 5506

trent.holsman@cbre.com

License #: 01449957

Madison Dutra

619 993 2520

madison.dutra@cbre.com

License #: 02041936

Conor Famulener

510 847 0659

conor.famulener@cbre.com

License #: 01438818



475 Sansome St, San Francisco, CA, 94111

© 2024 CBRE, Inc. All rights reserved. This information has been obtained from sources believed reliable, but has not been verified for accuracy or completeness. You should conduct a careful, independent investigation of the property and verify all information. Any reliance on this information is solely at your own risk. CBRE and the CBRE logo are service marks of CBRE, Inc. All other marks displayed on this document are the property of their respective owners, and the use of such logos does not imply any affiliation with or endorsement of CBRE. Photos herein are the property of their respective owners. Use of these images without the express written consent of the owner is prohibited.